



806 Wyoming Ave., Creston, Iowa 50801 Phone: (641)782-4005

UNITED STATES PUBLIC LAND SURVEY CORNER CERTIFICATE OF

LAND SURVEY MONUMENTS SITUATED IN SECTION 24, TOWNSHIP 77 NORTH, RANGE 28 WEST OF THE 5TH P.M. IN MADISON COUNTY, IOWA.
 PREVIOUSLY RECORDED IN NO CERTIFICATE OF RECORD IN COUNTY RECORDER'S OFFICE.

MONUMENT DESCRIPTION AND REMARKS: ① SW COR. NE1/4 NE1/4 SEC. 24-77-28, SET COTTON GIN SPIKE ON LINE & USING SINGLE PRORATED DISTANCE FROM HIGHWAY PLANS AND EASEMENTS OF RECORD FROM FOUND MONUMENTS AT THE NW COR. NE1/4 NE1/4 & SW COR. SE1/4 NE1/4 SEC. 24-77-28, CORNER FALLS 4.4' EAST OF CENTERLINE OF HWY. AND IN LINE W/ FENCE RUNNING WEST.

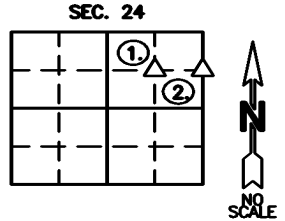

② SE COR. NE1/4 NE1/4 SEC. 24-77-28, SET 5/8" X 24" REBAR W/ YPC# 24655 AT MID POINT BETWEEN MONUMENTS AT THE NE & E1/4 COR. SEC. 24-77-28. CORNER FALLS IN CULTIVATED FIELD.

(SHOW A MINIMUM OF THREE REFERENCE TIES TO DURABLE PHYSICAL OBJECTS, RELEVANT MONUMENTS, AND PHYSICAL CONDITIONS THAT WILL ENABLE RECOVERY OF THE CORNER)

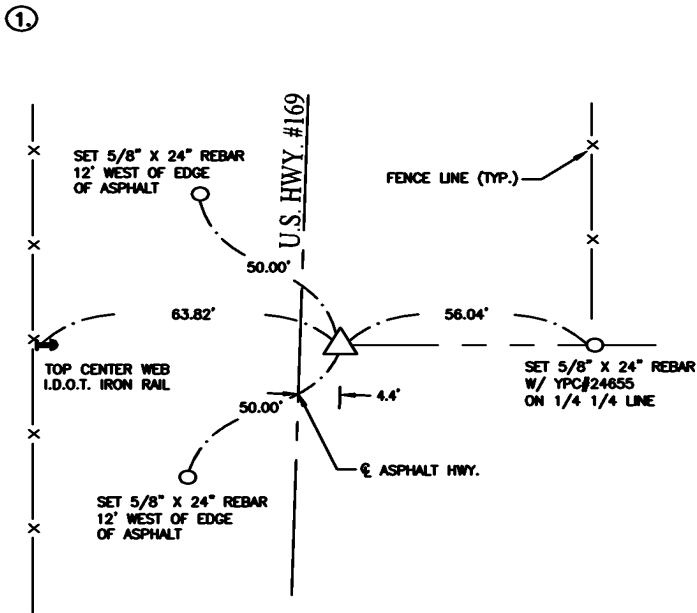

SW COR. NE1/4 NE1/4 SEC. 24, T-77-N, R-28-W,
 SET COTTON GIN SPIKE

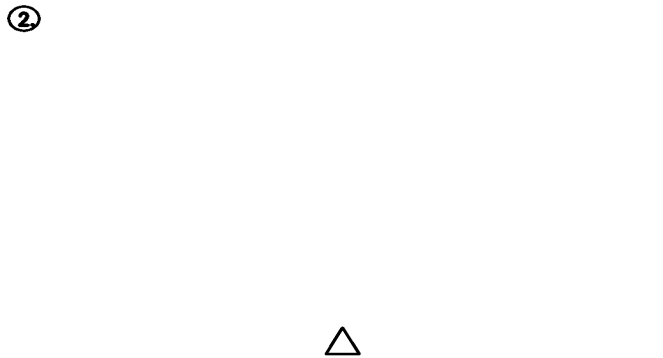

SE COR. NE1/4 NE1/4 SEC. 24, T-77-N, R-28-W,
 SET 5/8" X 24" REBAR W/ YPC#24655

I hereby certify that this land surveying document was prepared and the related survey work was performed by me or under my direct personal supervision and that I am a duly licensed Professional Land Surveyor under the laws of the State of Iowa.

Joshua E. Schneider 1-19-2023 Date
 Joshua E. Schneider, P.L.S.
 License number: 24655
 My license renewal date is December 31, 2023
 This page only covered by this seal:



LIST OF CORNERS TO BE INDEXED

CORNERS	SECTIONS	TOWNSHIP	RANGE
SW NE1/4 NE1/4	24	77	28
SE NE1/4 NE1/4	24	77	28

SURVEY FOR: DREAM DIRT
 DATE: 1-18-23
 PROJECT NO. 6023602