



806 Wyoming Ave., Creston, Iowa 50801 Phone: (641)782-4005

**UNITED STATES PUBLIC LAND SURVEY CORNER CERTIFICATE OF**

LAND SURVEY MONUMENTS SITUATED IN SECTION 24, TOWNSHIP 77 NORTH, RANGE 28 WEST OF THE 5TH P.M. IN MADISON COUNTY, IOWA.  
 PREVIOUSLY RECORDED IN NO CERTIFICATE OF RECORD IN COUNTY RECORDER'S OFFICE.

MONUMENT DESCRIPTION AND REMARKS: ① CENTER SEC. 24-77-28, FOUND 1/2" OLD RUSTY IRON PIN, 3" DEEP NEXT TO LARGE CORNER POST, SEARCH FOR STONE, FOUND NONE, PIN WAS SET UNDER STONE PER IOWA STATE HIGHWAY COMMISSION LAND CORNER SURVEY DATED 1943, THEREFORE ACCEPTED PIN & RETIED CORNER DUE TO MISSING TIES.  
 ② E1/4 COR. SEC. 24-77-28, FOUND ANCIENT CORNER POST ROTTED OFF AT BASE PER TIES FROM PREVIOUSLY MENTIONED SURVEY, SET 5/8" X 24" REBAR W/ YPC#24655 AT RECORD DIMENSION FROM BRASS PLUG AT SW COR. SE1/4 NE1/4 SEC. 24-77-28 NEAR CORNER POST & TIED OUT REBAR AS CORNER.

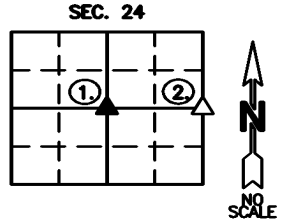

(SHOW A MINIMUM OF THREE REFERENCE TIES TO DURABLE PHYSICAL OBJECTS, RELEVANT MONUMENTS, AND PHYSICAL CONDITIONS THAT WILL ENABLE RECOVERY OF THE CORNER)

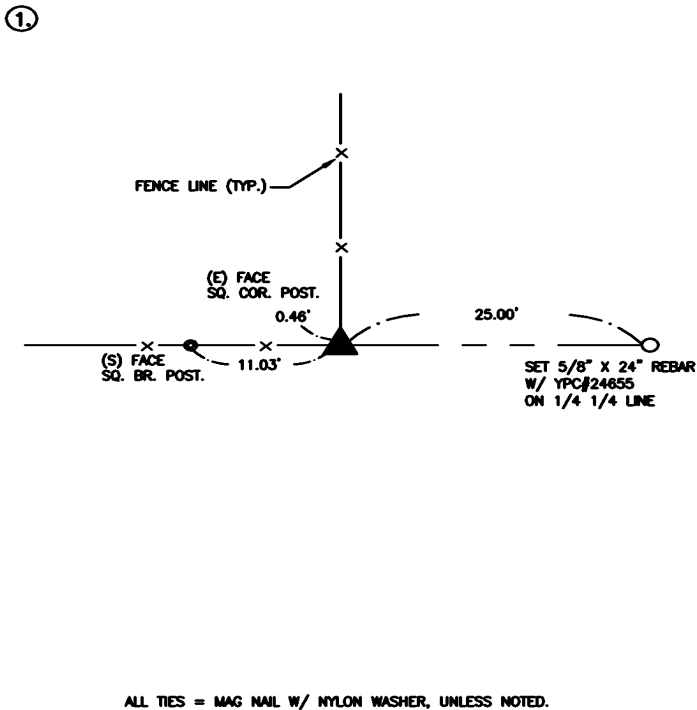

CENTER SEC. 24, T-77-N, R-28-W,  
 FOUND 1/2" OLD RUSTY PIN

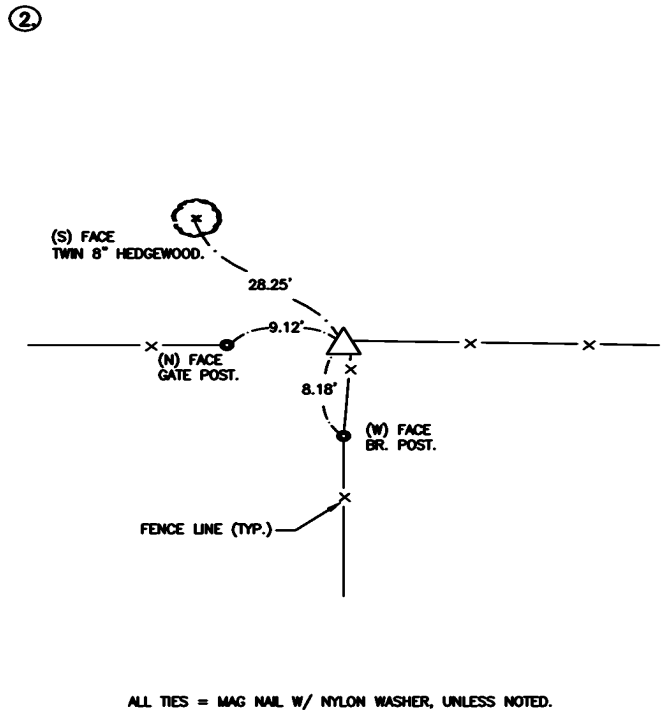

E1/4 COR. SEC. 24, T-77-N, R-28-W,  
 SET 5/8" X 24" REBAR W/ YPC#24655

I hereby certify that this land surveying document was prepared and the related survey work was performed by me or under my direct personal supervision and that I am a duly licensed Professional Land Surveyor under the laws of the State of Iowa.

*Joshua E. Schneider* 1-19-2023 Date  
 Joshua E. Schneider, P.L.S.  
 License number: 24655  
 My license renewal date is December 31, 2023  
 This page only covered by this seal:



**LIST OF CORNERS TO BE INDEXED**

| CORNERS | SECTIONS | TOWNSHIP | RANGE |
|---------|----------|----------|-------|
| CENTER  | 24       | 77       | 28    |
| E1/4    | 24       | 77       | 28    |

SURVEY FOR: DREAM DIRT  
 DATE: 1-18-23  
 PROJECT NO. 6023602