



806 Wyoming Ave., Creston, Iowa 50801 Phone: (641)782-4005

**UNITED STATES PUBLIC LAND SURVEY CORNER CERTIFICATE OF**

LAND SURVEY MONUMENTS SITUATED IN SECTION 31, TOWNSHIP 74 NORTH, RANGE 28 WEST OF THE 5TH P.M. IN MADISON COUNTY, IOWA. PREVIOUSLY RECORDED IN SEE BELOW IN COUNTY RECORDER'S OFFICE.

MONUMENT DESCRIPTION AND REMARKS: ① N1/4 COR. SEC. 31-74-28, FOUND 1/2" REBAR W/ YPC#6808  
 2" DEEP PER CERTIFICATE FILED IN BOOK 2008, PAGE 1632, ACCEPTED LOCATION EVEN THOUGH REBAR FALLS 1.05' NORTH & 1.20' EAST OF A CALCULATED POINT BY DOUBLING OVER FROM CORNERS FOUND 1/4 & 1/2 MILE EAST AS MENTIONED ON PREVIOUS CERTIFICATE, THEREFORE RETIED CORNER DUE TO MISSING TIES.  
 ② CENTER SEC. 31-74-28, CALCULATED A POINT BY EXTENDING FENCES RUNNING FROM THE SOUTH & WEST, PROBED A 4' DIA. AREA, FOUND NOTHING, SET 5/8" X 24" REBAR W/ YPC#24655 AT CALCULATED POINT.

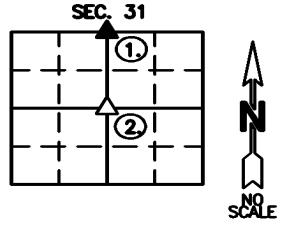

(SHOW A MINIMUM OF THREE REFERENCE TIES TO DURABLE PHYSICAL OBJECTS, RELEVANT MONUMENTS, AND PHYSICAL CONDITIONS THAT WILL ENABLE RECOVERY OF THE CORNER)

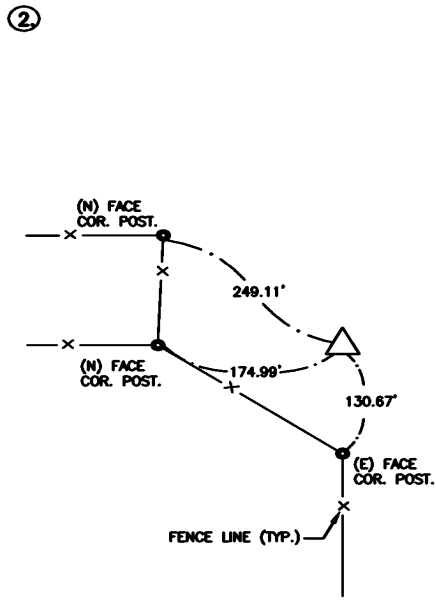
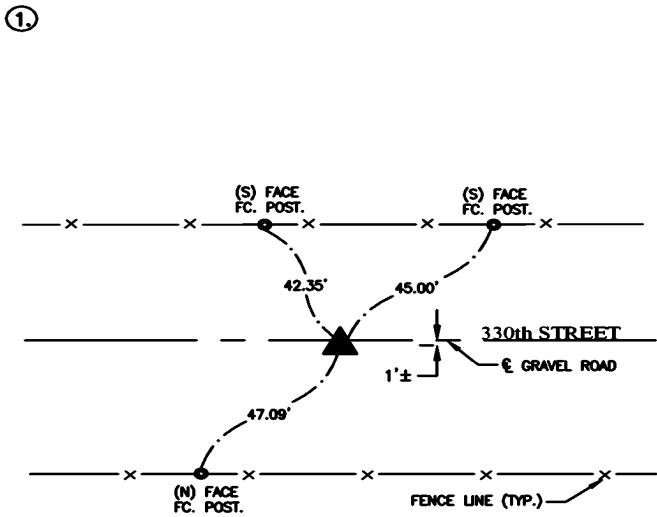

ALL TIES = MAG NAIL W/ NYLON WASHER, UNLESS NOTED.

ALL TIES = MAG NAIL W/ NYLON WASHER, UNLESS NOTED.

**N1/4 COR. SEC. 31, T-74-N, R-28-W,  
 FOUND 1/2" REBAR W/ YPC#6808**

**CENTER SEC. 31, T-74-N, R-28-W,  
 SET 5/8" X 24" REBAR W/ YPC#24655**

I hereby certify that this land surveying document was prepared and the related survey work was performed by me or under my direct personal supervision and that I am a duly licensed Professional Land Surveyor under the laws of the State of Iowa.

*Joshua E. Schneider* 12-28-2022  
 Joshua E. Schneider, P.L.S. Date  
 License number: 24655  
 My license renewal date is December 31, 2023  
 This page only covered by this seal:



**LIST OF CORNERS TO BE INDEXED**

| CORNERS | SECTIONS | TOWNSHIP | RANGE |
|---------|----------|----------|-------|
| N1/4    | 31       | 74       | 28    |
| CENTER  | 31       | 74       | 28    |

SURVEY FOR: BENJAMIN J. WAIGAND  
 DATE: 12-28-22  
 PROJECT NO. 6022864