



806 Wyoming Ave., Creston, Iowa 50801 Phone: (641)782-4005

UNITED STATES PUBLIC LAND SURVEY CORNER CERTIFICATE OF

LAND SURVEY MONUMENTS SITUATED IN SECTION 1, TOWNSHIP 75 NORTH, RANGE 27 WEST OF THE 5TH P.M. IN MADISON COUNTY, IOWA.
 PREVIOUSLY RECORDED IN SEE BELOW IN COUNTY RECORDER'S OFFICE.

MONUMENT DESCRIPTION AND REMARKS: ① NW COR. SW1/4 NW1/4 SEC. 1-75-27, FOUND 3/4" GAS PIPE W/ YPC #3169, 2" DEEP IN ROAD DITCH PER EXISTING CORNER CERTIFICATE FILED IN BOOK 1 AT PAGE 364, ACCEPTED PIPE & RETIED CORNER DUE TO MISSING TIES.
 ② NE COR. SW1/4 NW1/4 SEC. 1-75-27, FOUND 5/8" REBAR W/OPC#7955 AT SURFACE PER EXISTING CORNER CERTIFICATE FILED IN BOOK 1 AT PAGE 365, ACCEPTED REBAR & RETIED CORNER DUE TO MISSING TIES.

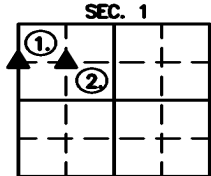

(SHOW A MINIMUM OF THREE REFERENCE TIES TO DURABLE PHYSICAL OBJECTS, RELEVANT MONUMENTS, AND PHYSICAL CONDITIONS THAT WILL ENABLE RECOVERY OF THE CORNER)

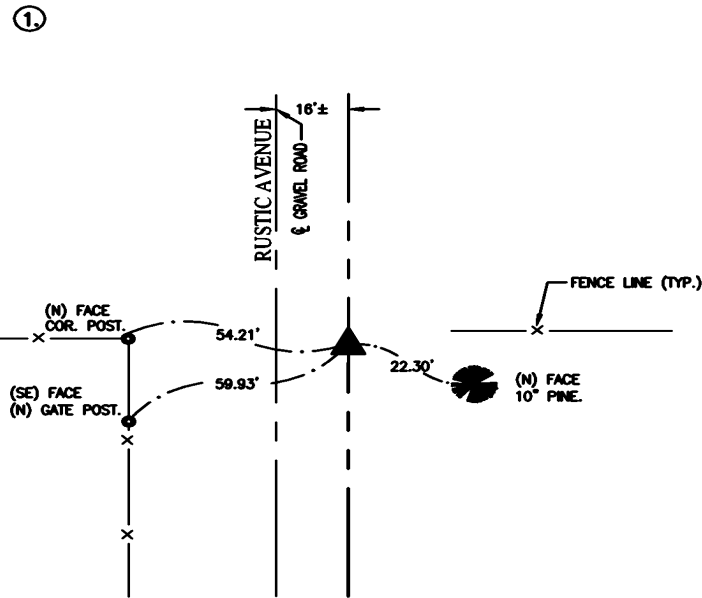

ALL TIES = MAG NAIL W/ NYLON WASHER, UNLESS NOTED.

NW COR. SW1/4 NW1/4 SEC. 1, T-75-N, R-27-W,
 FOUND 3/4" GAS PIPE W/ YPC#3169

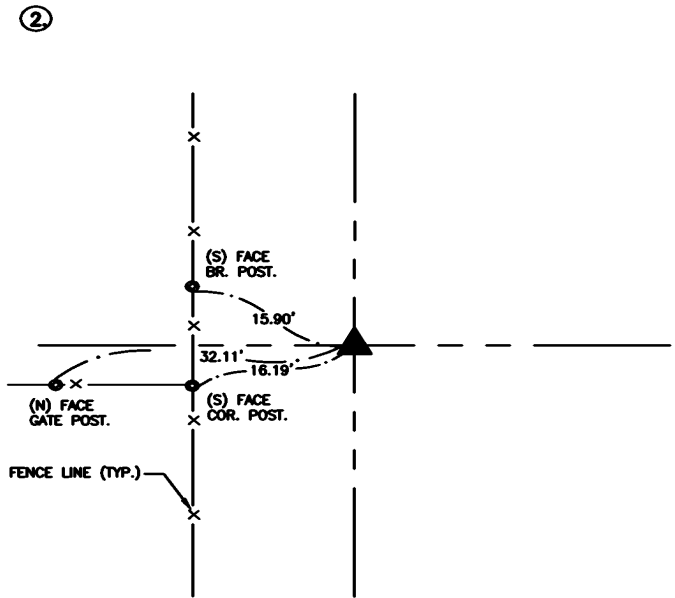

ALL TIES = MAG NAIL W/ NYLON WASHER, UNLESS NOTED.

NE COR. SW1/4 NW1/4 SEC. 1, T-75-N, R-27-W,
 FOUND 5/8" REBAR W/ OPC#7955

I hereby certify that this land surveying document was prepared and the related survey work was performed by me or under my direct personal supervision and that I am a duly licensed Professional Land Surveyor under the laws of the State of Iowa.

Joshua E. Schneider 9-27-2022 Date
 Joshua E. Schneider, P.L.S.
 License number: 24655
 My license renewal date is December 31, 2023
 This page only covered by this seal:



LIST OF CORNERS TO BE INDEXED

| CORNERS | SECTIONS | TOWNSHIP | RANGE |
|----------------|----------|----------|-------|
| NW SW1/4 NW1/4 | 1 | 75 | 27 |
| NE SW1/4 NW1/4 | 1 | 75 | 27 |

SURVEY FOR: HAWKEYE FARM MGMT.
 DATE: 9-26-22
 PROJECT NO. 6022813