



Document 2022 1491

Book 2022 Page 1491 Type 06 043 Pages 1

Date 5/19/2022 Time 2:50:58PM

Rec Amt \$.00

INDX  
ANNO  
SCAN

LISA SMITH, COUNTY RECORDER  
MADISON COUNTY IOWA

CHEK

Prepared By: Michael James Hackett, Madison County Engineer's Office, 1105 E. Court Ave., Winterset, Ia. 50273, Tel. (515) 462-1136

# UNITED STATES PUBLIC LAND SURVEY CORNER CERTIFICATE OF

Land Survey Monuments situated in Section 21, Township 75 N, Range 26 W, of the Fifth Principal Meridian, Madison County, Iowa.  
Previously recorded in Book 1, Page 76 in County Recorder's Office.  
(book, page, document number, etc.)

(Show reason for preparing this certificate, the evidence and detailed procedures used in establishing the corner positions and monumentation found or placed.)

Monument Description and Remarks: Previous monument found during Madison County project FM-C061(117)--55-61 A.C.C. pavement resurfacing and reconstruction. Found C.I.R. yellow 5041 cap 8" deep in north shoulder of pavement. The corner position was not disturbed during construction. Reestablished ties during the resurfacing and reconstruction. Accepted position.

## PLAN VIEW

(Show a minimum of three reference ties to durable physical objects, relevant monuments and physical conditions that will enable recovery of the corner.)

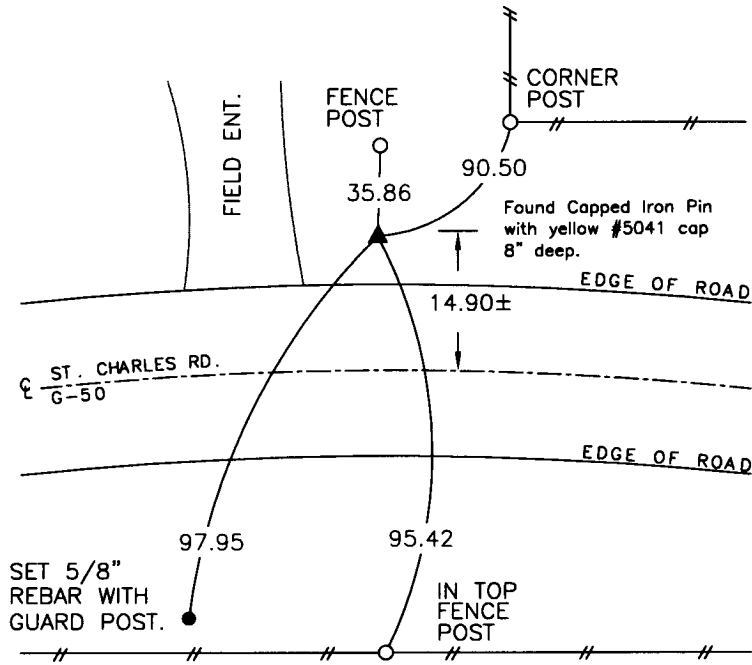

NW. COR., SW. 1/4 NE. 1/4 SEC. 21

NOTE: ALL TIES TO "X" NAILS UNLESS NOTED

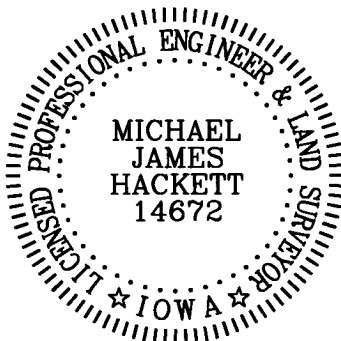

I hereby certify that this land surveying document was prepared and the related survey work was performed by me or under my direct personal supervision and that I am a duly Licensed Land Surveyor under the laws of the State of Iowa.

Signed Michael James Hackett Date 4/6/2022  
Michael James Hackett

Iowa license number 14672.  
My license renewal date is 12/31/2022.  
Pages covered by this seal: 1.

FM-C061(117)--55-61  
0-11