



Document 2020 GW4364

Book 2020 Page 4364 Type 43 001 Pages 3

Date 11/10/2020 Time 11:53:52AM

Rec Amt \$.00

INDX  
ANNO  
SCAN

LISA SMITH, COUNTY RECORDER  
MADISON COUNTY IOWA

CHEK

**REAL ESTATE TRANSFER - GROUNDWATER HAZARD STATEMENT  
TO BE COMPLETED BY TRANSFEROR**

**TRANSFEROR:**

Name John E. Garmon

Address 11 South Branch Lane, Eldon, MO 65026

Number and Street or RR

City, Town or P.O.

State

Zip

**TRANSFeree:**

Name Trustee of the Scott and Kimberly Palmer Revocable Trust U/A/D 8/31/2018

Address 3248 305th Lane, Truro, IA 50257

Number and Street or RR

City, Town or P.O.

State

Zip

Address of Property Transferred:

Land in Madison County, Iowa, IA

Number and Street or RR

City, Town or P.O.

State

Zip

Legal Description of Property: (Attach if necessary) See Legal Description attached hereto.

**1. Wells (check one)**

There are no known wells situated on this property.

There is a well or wells situated on this property. The type(s), location(s) and legal status are stated below or set forth on an attached separate sheet, as necessary.

**2. Solid Waste Disposal (check one)**

There is no known solid waste disposal site on this property.

There is a solid waste disposal site on this property and information related thereto is provided in Attachment #1, attached to this document.

**3. Hazardous Wastes (check one)**

There is no known hazardous waste on this property.

There is hazardous waste on this property and information related thereto is provided in Attachment #1, attached to this document.

**4. Underground Storage Tanks (check one)**

There are no known underground storage tanks on this property. (Note exclusions such as small farm and residential motor fuel tanks, most heating oil tanks, cisterns and septic tanks, in instructions.)

There is an underground storage tank on this property. The type(s), size(s) and any known substance(s) contained are listed below or on an attached separate sheet, as necessary.

**5. Private Burial Site (check one)**

- There are no known private burial sites on this property.
- There is a private burial site on this property. The location(s) of the site(s) and known identifying information of the decedent(s) is stated below or on an attached separate sheet, as necessary.

**6. Private Sewage Disposal System (check one)**

- All buildings on this property are served by a public or semi-public sewage disposal system.
- This transaction does not involve the transfer of any building which has or is required by law to have a sewage disposal system.
- There is a building served by private sewage disposal system on this property or a building without any lawful sewage disposal system. A certified inspector's report is attached which documents the condition of the private sewage disposal system and whether any modifications are required to conform to standards adopted by the Department of Natural Resources. A certified inspection report must be accompanied by this form when recording.
- There is a building served by private sewage disposal system on this property. Weather or other temporary physical conditions prevent the certified inspection of the private sewage disposal system from being conducted. The buyer has executed a binding acknowledgment with the county board of health to conduct a certified inspection of the private sewage disposal system at the earliest practicable time and to be responsible for any required modifications to the private sewage disposal system as identified by the certified inspection. A copy of the binding acknowledgment is attached to this form.
- There is a building served by private sewage disposal system on this property. The buyer has executed a binding acknowledgment with the county board of health to install a new private sewage disposal system on this property within an agreed upon time period. A copy of the binding acknowledgment is provided with this form.
- There is a building served by private sewage disposal system on this property. The building to which the sewage disposal system is connected will be demolished without being occupied. The buyer has executed a binding acknowledgment with the county board of health to demolish the building within an agreed upon time period. A copy of the binding acknowledgment is provided with this form. [Exemption #9]
- This property is exempt from the private sewage disposal inspection requirements pursuant to the following exemption [Note: for exemption #9 use prior check box]: \_\_\_\_\_.
- The private sewage disposal system has been installed within the past two years pursuant to permit number \_\_\_\_\_.

**Information required by statements checked above should be provided here or on separate sheets attached hereto:**

WELL ON EAST side of EQLI PROPERTY

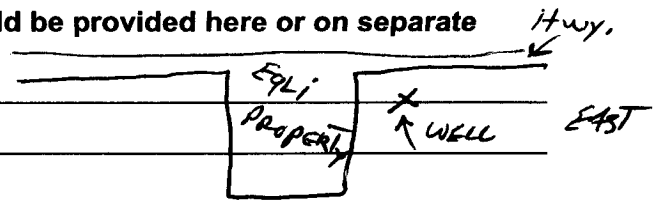

**I HEREBY DECLARE THAT I HAVE REVIEWED THE INSTRUCTIONS FOR THIS FORM AND THAT THE INFORMATION STATED ABOVE IS TRUE AND CORRECT.**

Signature: *Shirley L. ...*  
(Transferor or Agent)

Telephone No.: (641) 414-6645

## Legal Description

The Southwest Quarter ( $\frac{1}{4}$ ) of Section Twelve (12), Township Seventy-four (74) North, Range Twenty-six (26) West of the 5th P.M., Madison County, Iowa, **EXCEPT** the following described tracts, to-wit:

1. Parcel "A", located in the Northwest Quarter ( $\frac{1}{4}$ ) of the Southwest Quarter ( $\frac{1}{4}$ ) of said Section Twelve (12), containing 3.000 acres, as shown in Plat of Survey filed in Book 2, Page 520, on December 6, 1994 in the Office of the Recorder of Madison County, Iowa;
2. Parcel "B", located in the Southwest Quarter ( $\frac{1}{4}$ ) of the Southwest Quarter ( $\frac{1}{4}$ ) of said Section Twelve (12), containing 7.10 acres, as shown in Plat of Survey filed in Book 2, Page 627, on November 8, 1995 in the Office of the Recorder of Madison County, Iowa;
3. Parcel "J", located in the West Half ( $\frac{1}{2}$ ) of the Southwest Quarter ( $\frac{1}{4}$ ) of said Section Twelve (12), containing 4.00 acres, as shown in Plat of Survey filed in Book 2017, Page 3807, on December 4, 2017 in the Office of the Recorder of Madison County, Iowa;
4. A tract of land located in the Northwest Quarter ( $\frac{1}{4}$ ) of the Southwest Quarter ( $\frac{1}{4}$ ) of said Section Twelve (12), more particularly described as follows, to-wit: Beginning at a point in the Center line of a gravel road 2989 feet South of the Northwest corner of said Section Twelve (12), thence East 75 feet, thence South 75 feet, thence West 75 feet, thence North 75 feet to the point of beginning;
5. That part thereof conveyed to the State of Iowa for highway purposes, as shown in Warranty Deed filed in Book 88, Page 509, on October 5, 1957 in the Office of the Recorder of Madison County, Iowa.